

VILLAGE OF LIPTON

April 2026 Newsletter

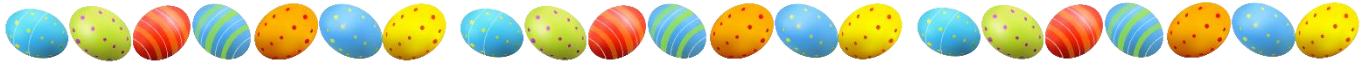

Kids Easter Party Lipton Fire Hall

Sunday, April 5 10:00 a.m. – 12:00 p.m.
Come check out the fire trucks and pick up an Easter bag!



Office Closure for SUMA and Easter

The Village Office will be closed from April 12th to April 15th, 2026
for the annual SUMA Convention.

The Office will be closed on April 3 and 6, 2026 for Easter.
Have a safe and hoppy long weekend!



Food Truck season is coming!

STAY
POSTED
FOR
MORE
DATES



May 20
Asian Food Trip

July 10
Salsa Town
Latina Truck





Facebook.com/FowlLanguageComics FowlLanguageComics.com ©Brian Gordon

High Tea

April 19, 1 to 4 PM
Lipton Trading Post
\$20 per person

Menu

- Egg Salad and cucumber sandwiches
- Meat and veggie skewers
- Crackers with red pepper jelly and cream cheese
- Lemon pound cake
- Cream puffs
- Mini cheesecakes
- Jam jam cookies
- Fruit kabobs

Please register with Joy at
☎ 306-331-9225

Quilting Bee

Every Thursday in April

6:30 pm

Lipton Rec Centre

— For information —
Call Joye 306-331-9225

*Experienced and
Beginner Quilters
welcome!*

Silk Scarf Painting Workshop

April 12

Monday, April 13 class is full.

Two hour class starting at 6 PM
Lipton Trading Post
please bring an apron
or an old shirt to wear
\$30 a person

Pre-register with Joye at 306-331-9225



Brett's
Home cooking

2026 Spring Meal Orders Now Accepted

Cooking taking place April 24-26

Foil & Plastic Containers

\$14/meal

Contact Brett for an order form

Brett's home cooking on Facebook

or

306-331-7971

Lipton Volunteer Fire Dept.



The second annual LVFD Tournament held on March 14 was a success!

LIPTON VOLUNTEER FISHING TOURNAMENT 2026 WINNERS
45 TEAMS 3 YOUTH ENTRIES 44 FISH CAUGHT & RELEASED

FIRST FISH CAUGHT 13oz PERCH - COREY & EROL TAWIYAKA

SMALLEST WALLEYE 2oz -JEFF & MARCHALL MILLER

SIDE BET NORTHERN PIKE 3LB - TRENT & LYNDON PREGITZER

SIDE BET PERCH 1LB 10oz - BRENDAN RYDER & NATHANEL DEEGAN

3 HEAVIEST WEIGHT COMBINED WALLEYE

3rd PLACE 1 POUND 10oz - KEITH & KASHMAN RYDER

2nd PLACE 1 POUND 12oz - ROB & HOLLY PARISIAN

1st PLACE 1 POUND 14oz - JEFF & MARCHALL MILLER

KIDS ENTRY WINNERS

RYKER KAISUATUM, NOVA TOMOLAK & LEVI SABISTON

LIPTON SCHOOL DRAMA CLUB PRESENTS
A DINNER THEATRE PRODUCTION OF



SPAGHETTI WESTERN OR... MISSION IM-PASTA-BLE

★ BY: TRACY WELLS ★

FRIDAY
MAY 8
2026



7
PM

Location: Lipton School

TICKETS - \$25 PER ADULT \$ 15 PER CHILD (12 AND UNDER)

CALL LIPTON SCHOOL - 306- 336- 2200
TO RESERVE YOUR TICKETS BEFORE
MAY 1, 2026

THANK YOU
TO OUR
SPONSORS



Prairie Co-op

ProSoils



HUB



SYNERGYAG

TSL
MECHANICAL INC.

POKEY'S
TACKLE SHOP

+
Lipton Parks + Recreation



What song is the Easter Bunny's favorite?



"I wanna dance with somebunny."



Lipton School Community Council

Annual Meeting

Notification and Nominations are hereby called for representative Parent and Community Members

The following Statement defines eligibility to run as a representative parent and community member:

- Parents of students who are enrolled in the school (including parents who do not reside within the attendance area)
- Electors that reside within the school attendance area.

Note: These provisions do not limit or restrict the election of participation in voting of parents of students who may be employed by the school division and work in the particular school.

Nomination forms are available at Lipton School and must be returned to the school office by 3:30pm on April 13, 2026 For more information please contact Lindsey Akrigg @306.336.2200

"School Community Councils are advisory bodies charged with the responsibility of supporting student achievement, opportunities and well being at the school and community level"
(PVSD School Community Council operations manual, 2016)

Lipton School Library 1105 Erin Ave.

April 14, 2026 | 6:00 pm
Babysitting provided

North Valley Waste Auth.

SUMMER HOURS

Apr. 1 – Nov. 30

Mon to Saturday:

8 am – 4:30pm

Sun: Closed

CLOSED STAT HOLIDAYS

*Extreme weather events
can affect roads*

Library Hours

See calendar for this month's hours



Trading Post Hours

Friday: 11am-5pm

Saturday: 11am-5pm

Sunday - 11am-5pm

Notary Services

Notary services are offered at the office. \$10/signature.

Meeting Days

Council Meetings:

1st & 3rd Weds. 7pm.

Fire Dept. Meeting:

2nd and last Thurs

RM of Lipton Meeting:

3rd Tues of the month

New Horizons Meeting:

3rd Tues. 1:30 pm.

Rec Org: 2nd Wed. 7 pm.

Dates subject to change

BIG DEAL BOX

40 full sized cards!

40 FULL SIZED
CARDS
INDIVIDUALLY
CELLO WRAPPED
NESTLED IN A
PERFECT
KEEPSAKE BOX



FULL COLOUR CARDS - INSIDE, FRONT AND BACK WITH
MATCHING ENVELOPES

Embellishments include cut-outs, foil and glitter



SCC INCLUSIVE PLAYGROUND FUNDRAISER

HELP US RAISE \$\$\$ BY
PURCHASING A BOX OF CARDS!

GOAL 150 BOXES = \$2625.00

PROFIT

ORDER FORMS & PAYMENTS ARE DUE MAY 1ST, 2026
E-TRANSFER TO: liptoncouncil@hotmail.com
OR CASH PAYMENTS CAN BE BROUGHT BACK WITH YOUR
ORDER FORMS ON MAY 1ST, 2026.

PRIZE DRAW FOR THE FAMILY THAT SELLS THE MOST BOXES OF CARDS

THANKS FOR YOUR SUPPORT!

10% of the world
population is left-handed

The average bear will have
42 teeth

The most commonly used
letter in the English
alphabets is E

Around 8% of the world
population has an extra rib

Australia is the only
continent without an active
volcano

Cats have a hundred vocal
cords

Hummingbirds are the only
birds that can fly backward

Coins in the Trevi Fountain
are collected and given to
charity

Apples wake you up more
than coffee in the morning

Monopoly is the most played
board game in the world

There are 1,792 steps on
the Eiffel Tower

There are more chickens in
the world than there are
people

Easter Crossword

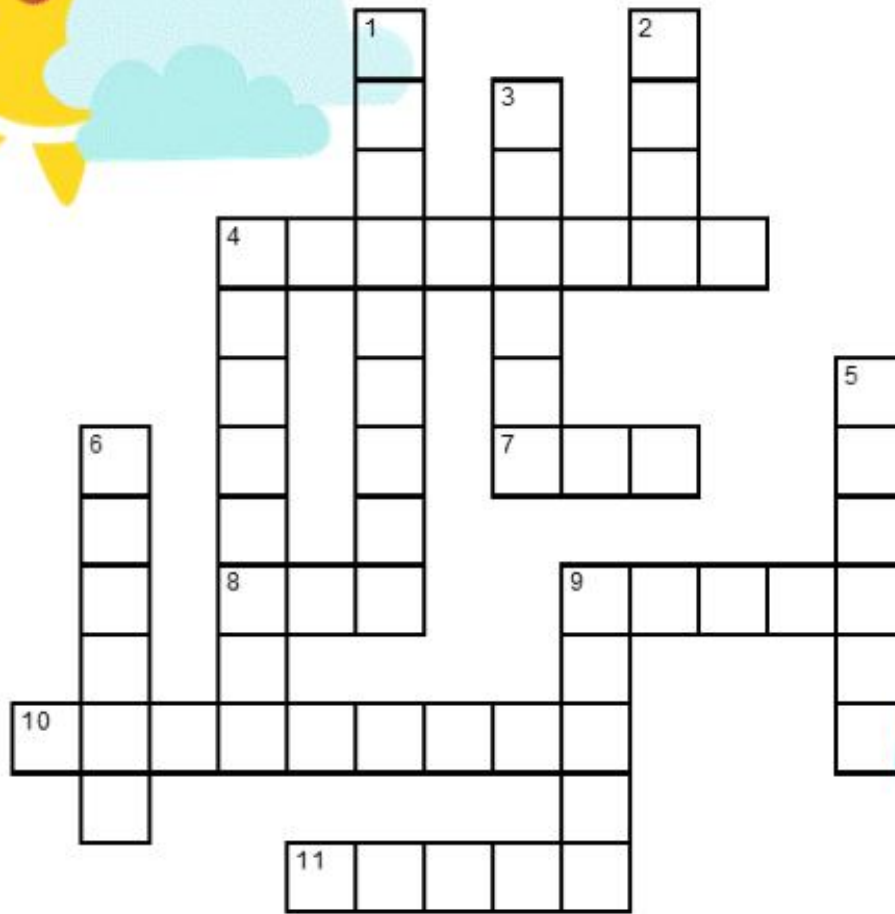

ACROSS

4. You might do this to eggs for Easter
7. A hen makes this
8. Used to color eggs
9. The hen's baby
10. Colorful candy you might find in an Easter basket
11. Peter Cottontail is one

DOWN

1. Eggs might be made from this
2. Look for eggs
3. Easter Day event
4. Yellow or white spring flower that grows from a bulb
5. What the Easter Bunny brings
6. A pretty hat worn on Easter
9. Don't eat too much of this or you might get a belly ache



LOTS FOR SALE IN LIPTON

The Village of Lipton has commercial and residential lots for sale. Available lots are outlined in red. Please contact the office for further details at 306-336-2505.

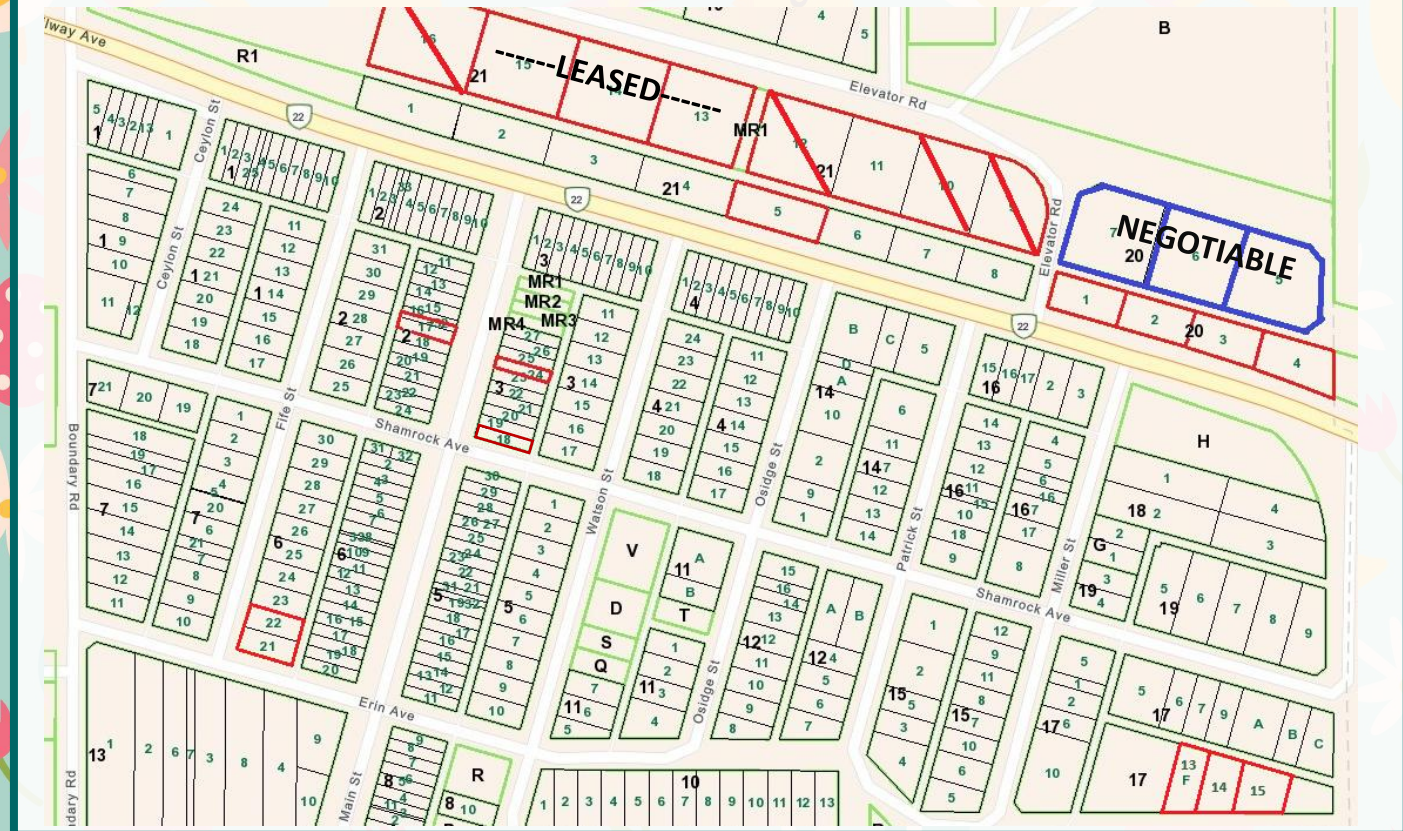

CENSUS JOBS

GR-309-26

Statistics Canada is hiring in your community for the 2026 Census!

Census information is used to plan programs and services that support employment, education, public transportation and healthcare.

Join the 2026 Census team for meaningful work and community impact.

Important to know:

- There are approximately 32,000 census jobs available across Canada.
- Pay is **\$25.87 per hour** for non-supervisory positions and **\$31.32 per hour** for supervisory positions, plus authorized expenses.
- The time frame for census jobs is between **March and July 2026**, depending on the position and location.
- You must be available to work flexible hours including days, evenings, and weekends.



Apply now and tell a friend
census.gc.ca/jobs

For assistance, please call **1-833-830-3106**
 Teletypewriter (TTY): **1-833-830-3109**

APRIL 2026



	Mon	Tues	Wed	Thu	Fri	Sat
			1	2 Recycling Quilting Bee Library Open 12-6	3 Good Friday Office Closed	4
5 HAPPY EASTER	6 Easter Monday Office Closed	7	8	9 Quilting Bee Library Open 12-6	10	11
12 SUMA – Office Closed Silk Scarf Painting	13 SUMA – Office Closed Silk Scarf Painting	14 SUMA – Office Closed SCC AGM Library Open 11-5	15 SUMA – Office Closed	16 Recycling Quilting Bee Library Open 12-6	17	18
19 High Tea	20	21	22 Library Open 11-5	23 Quilting Bee	24 Bingo at New Horizons Library Open 12-6	25
26	27	28 Library Open 11-5	29	30 Recycling Quilting Bee Library Open 12-6		